

**A66 Northern Trans-Pennine Project
TR010062**

**7.30 Issue Specific Hearing 3 (ISH3)
Post Hearing Submissions (including
written submissions of oral case):
Appendix G:
M6 Junction 40 Typical Sections (CH
450 & CH 9666)**

Planning Act 2008

Infrastructure Planning (Examination Procedure) Rules 2010

Deadline 5

14 March 2023

Infrastructure Planning

Planning Act 2008

**The Infrastructure Planning
(Examination Procedure)
Rules 2010**

A66 Northern Trans-Pennine Project
Development Consent Order 202x

**7.30 ISSUE SPECIFIC HEARING 3 (ISH3) POST HEARING
SUBMISSIONS (INCLUDING WRITTEN SUBMISSIONS OF
ORAL CASE): APPENDIX G: M6 JUNCTION 40 TYPICAL
SECTIONS (CH 450 & CH9666)**

Planning Inspectorate Scheme Reference	TR010062
Application Document Reference	7.30
Author:	A66 Northern Trans-Pennine Project Team, National Highways

Version	Date	Status of Version
Rev 1	14 March 2023	Deadline 5

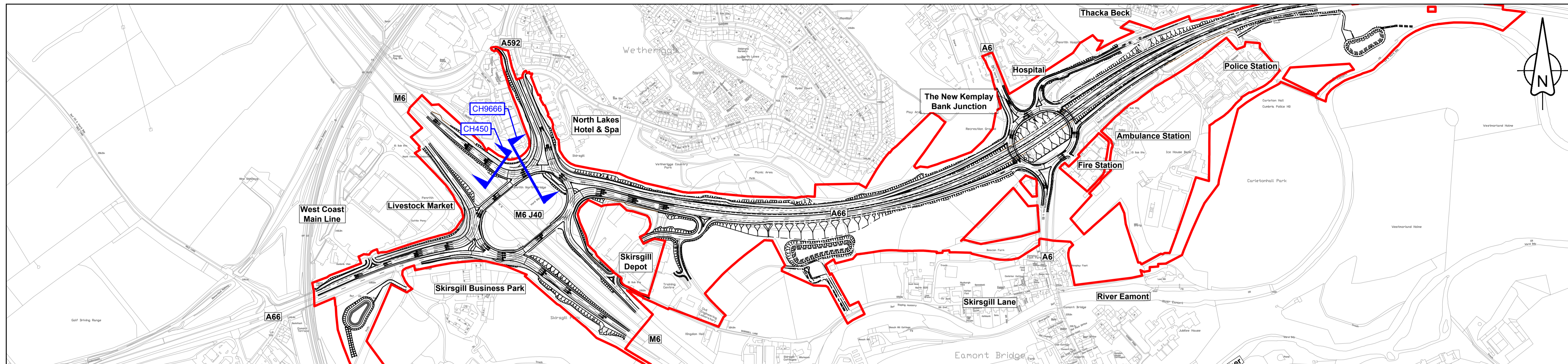

- ### NOTES
- ALL DIMENSIONS ARE IN METRES UNLESS NOTED OTHERWISE. THESE ENGINEERING SECTION DRAWINGS SHOULD BE READ IN CONJUNCTION WITH THE KEY PLAN AND ALONGSIDE OTHER PLANS AND DOCUMENTS IN THE DEVELOPMENT CONSENT ORDER APPLICATION, IN PARTICULAR, THE WORKS PLANS AND SCHEDULE 1 (AUTHORISED DEVELOPMENT) TO THE DEVELOPMENT CONSENT ORDER.
 - FOR CHAINAGE PLEASE REFER TO THE ENGINEERING SECTION DRAWINGS (PLAN AND PROFILES).
 - WORK NO. REFERENCES ARE DETAILED IN THE SCHEDULE 1 (AUTHORISED DEVELOPMENT) TO THE DEVELOPMENT CONSENT ORDER.
 - THE DESIGN SHOWN ON THESE ENGINEERING SECTION DRAWINGS IS ILLUSTRATIVE AND WILL BE SUBJECT TO THE DETAILED DESIGN DEVELOPMENT. ANY CHANGES WILL BE LIMITED TO BEING WITHIN THE ORDER LIMITS AND ANY OTHER CONSTRAINTS INCLUDED IN THE DEVELOPMENT CONSENT ORDER.

- ### KEY
- PROPOSED LEVEL
 - EXISTING LEVEL
 - ORDER LIMITS
 - SECTION MARKER WITH CHAINAGE REFERENCE

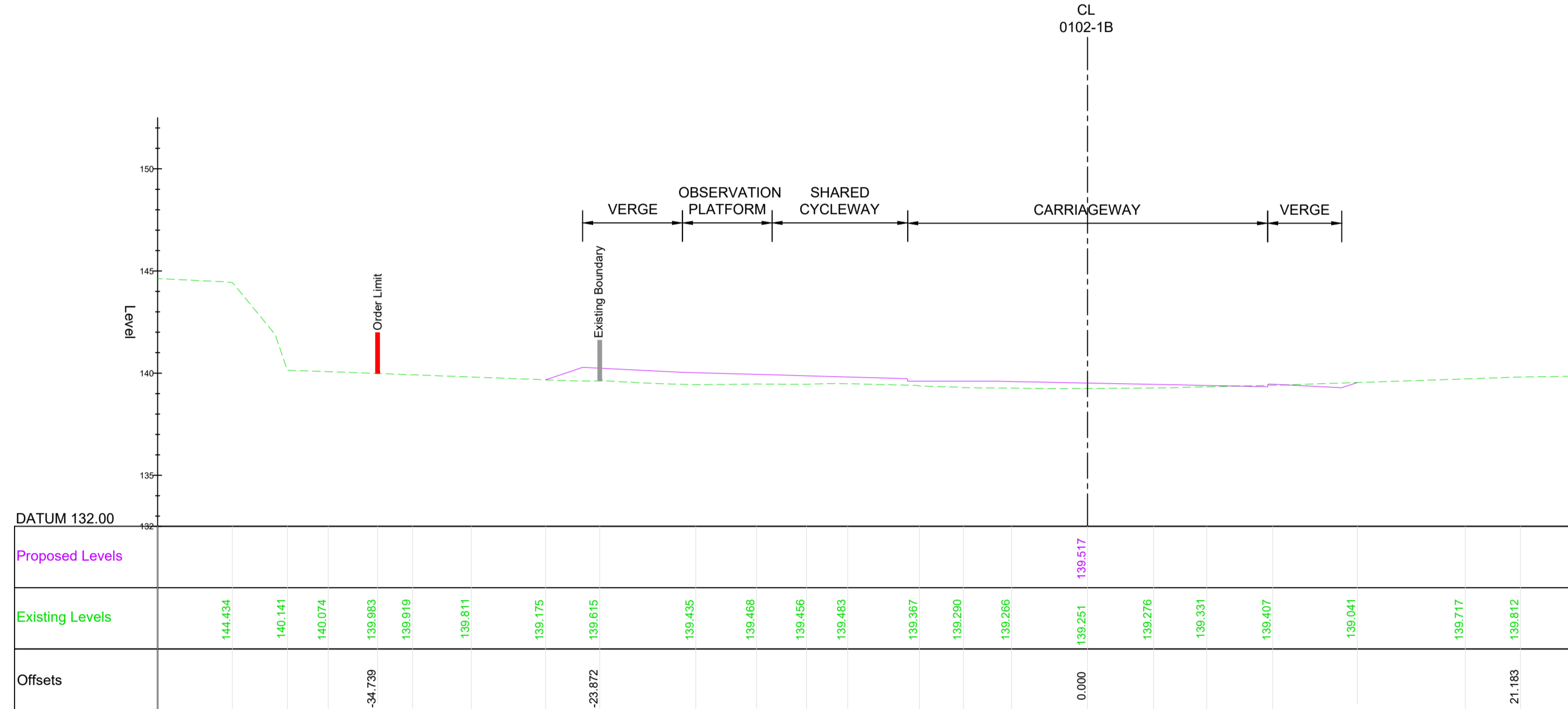

TYPICAL SECTION CH. 9666 WORK NO. 0102-1B
Scale 1:200

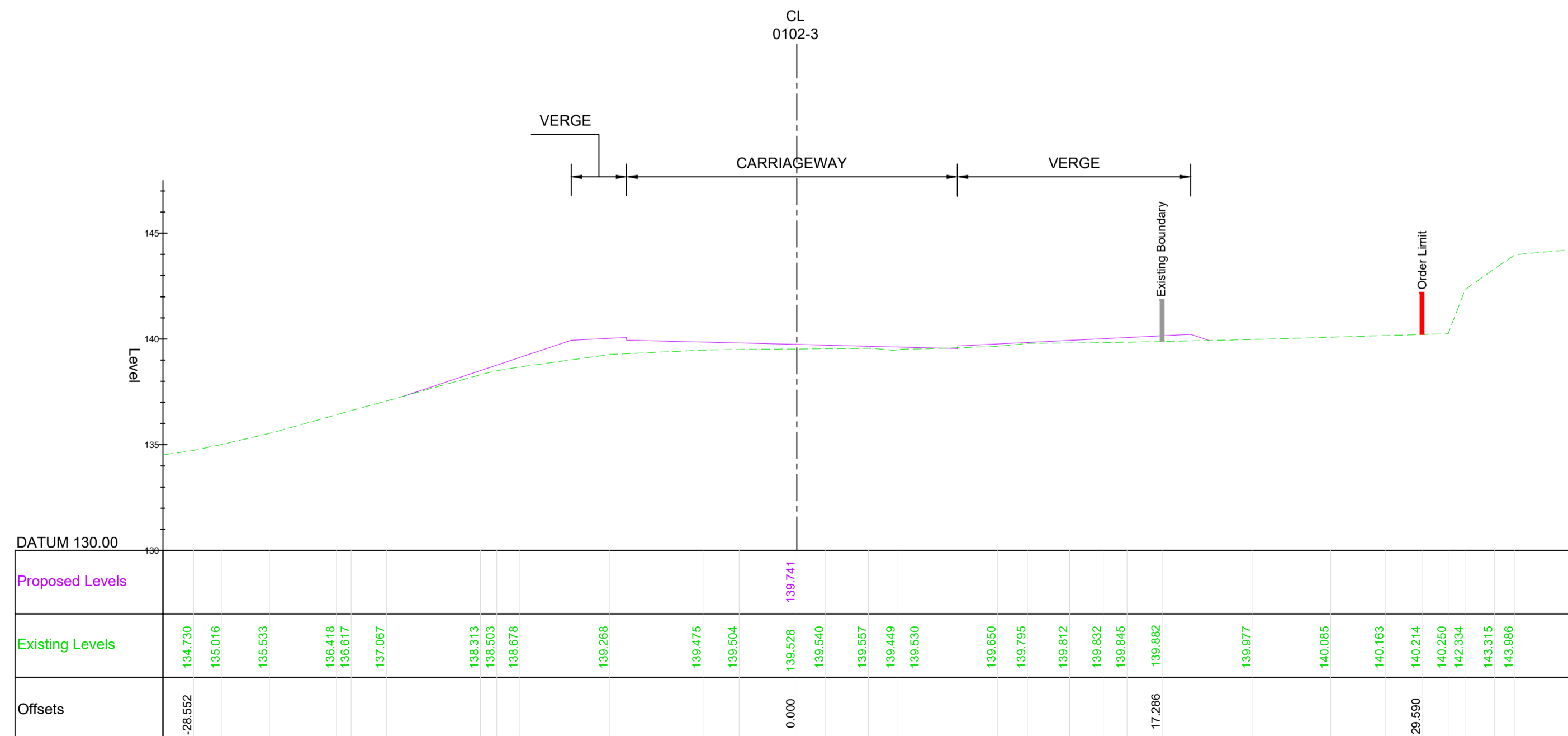

TYPICAL SECTION CH. 450 WORK NO. 0102-3
Scale 1:200

Revision	Created	Checked	Reviewed	Approved	Authorised
dd/mm/yy	dd/mm/yy	dd/mm/yy	dd/mm/yy	dd/mm/yy	dd/mm/yy

Designer
Amey OW Limited
Chancery Exchange
10 Furnival Street
London, EC4A 1AB

Client
3 Piccadilly Place
Manchester
M1 3BN

Project Name
A66 Northern Trans-Pennine

Drawing Title
**M6 Junction 40
Typical Sections
(CH 450 & CH 9666)
Sheet 1 of 1**

Project Ref. No.	Stage	Scale	@ A1
---	PCF3	1:5000	
		Dimensions	M

Drawing Number	Project	Originator	Volume
HE565627 - AMY - HAC -			
S0102	-SK-CH-	000011	
Location	Type	Role	Number

Suitability	Suitability Description	Revision
S1	Fit for Co-ordination	P02